

## DeLaval cluster SG-TF80

Fast milking with udder care in mind



### Efficient milking

In terms of milk extraction, DeLaval cluster SG-TF80 is the most efficient cluster for sheep and goats. It is based on the successful and well-proven Harmony® concept (central tubular milk extraction) that has been successfully used for milking cows for many years.

The advantages of this patented system include the following:

### Exceptional milk extraction capacity

Thanks to the 'top flow' concept, incoming milk is distributed over the claw base and is extracted through the centre pipe into the long milk tube.

DeLaval cluster SG-TF80 can evacuate up to 8 litres/minute and after milking no milk is left remaining inside the claw.

### Excellent vacuum stability

Due to its extraction capacity, the claw never floods. Vacuum fluctuations are reduced to a minimum and with a volume of 85 ml, and direct flange connections of the liners to the claw, DeLaval cluster SG-TF80 ensures that stable vacuum is applied to the teats.

### Quality milking = quality milk

Vacuum stability even at high flow rates minimises the risk of fall offs, cross infections and teat wash, thus reducing the risk of mastitis.

The 'top flow' concept and calibrated air bleed also reduce the mixture of air in the milk, which means gentle milk treatment and reduced lipolysis.

DeLaval cluster SG-TF80 high line with DeLaval liner S100-SILICONE

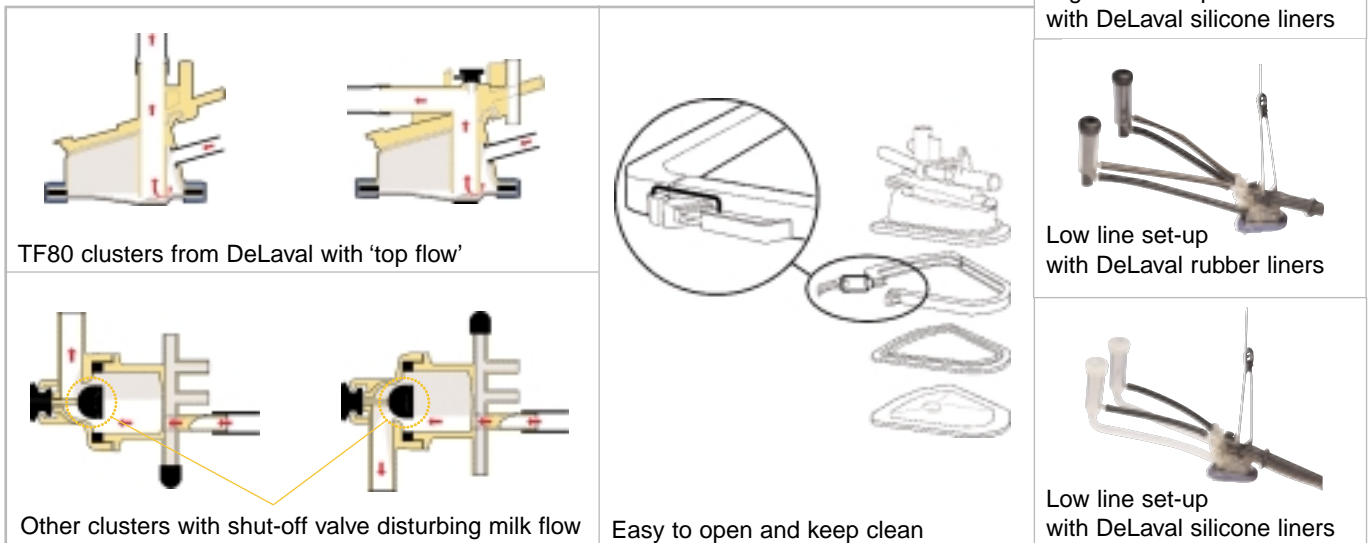

### How it works

Thanks to the flange connection, DeLaval cluster SG-TF80 collects milk from the liners without any restriction. After milk has been collected at the claw base it is then sucked through the centre pipe to the long milk tube.

Other clusters often have reductions at the liner connection and usually a shut-off valve that disturbs milk flow.

### The perfect match

Different liner sizes, flexible liner lips, optimal material (silicon and rubber), lightweight teatcups and correct positioning all ensure that DeLaval cluster SG-TF80 gives a perfect match with the teats. All these aspects improve teat stimulation, reduce slips and fall-offs and minimise the risk of mastitis.

### Transparent and resistant

The upper part of the cluster is made of transparent, high-quality polysulphone plastic. Together with the stainless-steel bottom part, this cluster is the ideal milking weight, while ensuring a long working life.

Due to its transparency, you can see if milk is flowing and avoid overmilking.

### Easy to keep clean

The cluster is equipped with a rapid opening seal-clamp in order to facilitate inspection and remove wool or straw from the claw. No screws, no bolts and no tools are needed to dismount it.

### Fits all situations

DeLaval cluster SG-TF80 is available in two versions: low and high line. Moreover, 4 different types of liners can be adapted to both situations.

That means that this cluster can be tailor-made to match the milking needs of your animals.

#### Data

##### DeLaval Cluster SG-TF80

Weight:	200 g
Height:	112 mm
Width:	110 mm
Pulse tube inlet:	8 mm
Milk tube inlet:	16 mm
Volume:	85 cc
Materials:	High-grade plastic and stainless steel



[www.delaval.com](http://www.delaval.com)